



MAHR GmbH

Rheingaustraße 98
D-65203 Wiesbaden
Tel.: +49 (0) 611/9 67 64-0
Fax: +49 (0) 611/9 67 64-19
www.mahr-gmbh.de
info@mahr-gmbh.de

Establishment South:
Langwiesenstraße 4
D-74363 Güglingen
Tel.: +49 (0) 7135/95 30-28
Fax: +49 (0) 7135/95 30-17
info@mahr-kompo.de

DIMENSIONED DRAWING ROTARY VALVE TYPE N/UL

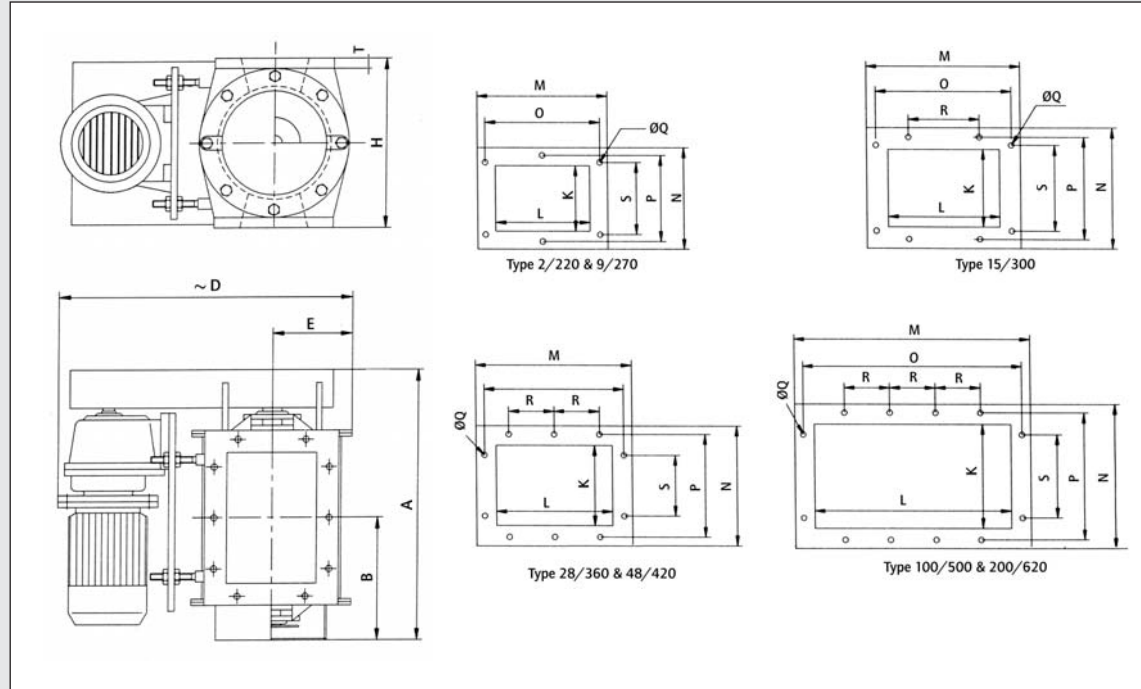

DIMENSION TABLE ROTARY VALVE TYPE N/UL

Type N/UL	theoret. displaced vol. 25 rpm (m³/h)	displaced volume (l)	Inlet (mm x mm)	Weight (kg)		A		B	
				1*	2*	Type N	Type UL	Type N	Type UL
5/220	7,5	5	150 x 200	135	70	520	555	235	255
9/270	13,5	9	180 x 200	160	95	520	555	235	255
15/300	22,5	15	200 x 280	190	125	600	655	270	290
28/360	42,0	28	250 x 350	300	225	670	730	310	330
48/420	72,0	48	300 x 450	350	295	700	850	375	395
100/500	150	100	350 x 550	510	450	920	990	445	465
200/620	300	200	460 x 860	1225	1125	1425	1425	780	800
300/650	450	300	460 x 1260	1600	1475	1725	1725	900	920

1* = weight with gear • 2* = weight without gear

Type N/UL	D	E	H	K	L	M	N	O	P	Q	R	S	T
5/220	590	145	325	150	200	285	235	260	205	12	-	180	13
9/270	600	170	375	180	200	285	265	260	235	12	-	180	13
15/300	635	202	420	200	280	380	300	350	270	14	180	200	15
28/360	700	223	485	250	350	450	350	420	320	14	150	180	16
48/420	720	255	560	300	450	550	400	520	370	14	190	230	22
100/500	900	300	655	350	550	670	460	640	430	14	140	250	24
200/620	975	375	780	460	860	1000	600	960	560	18	-	-	25
300/650	on customers request												



ANLAGENTECHNIKFÜR SCHÜTTGÜTER

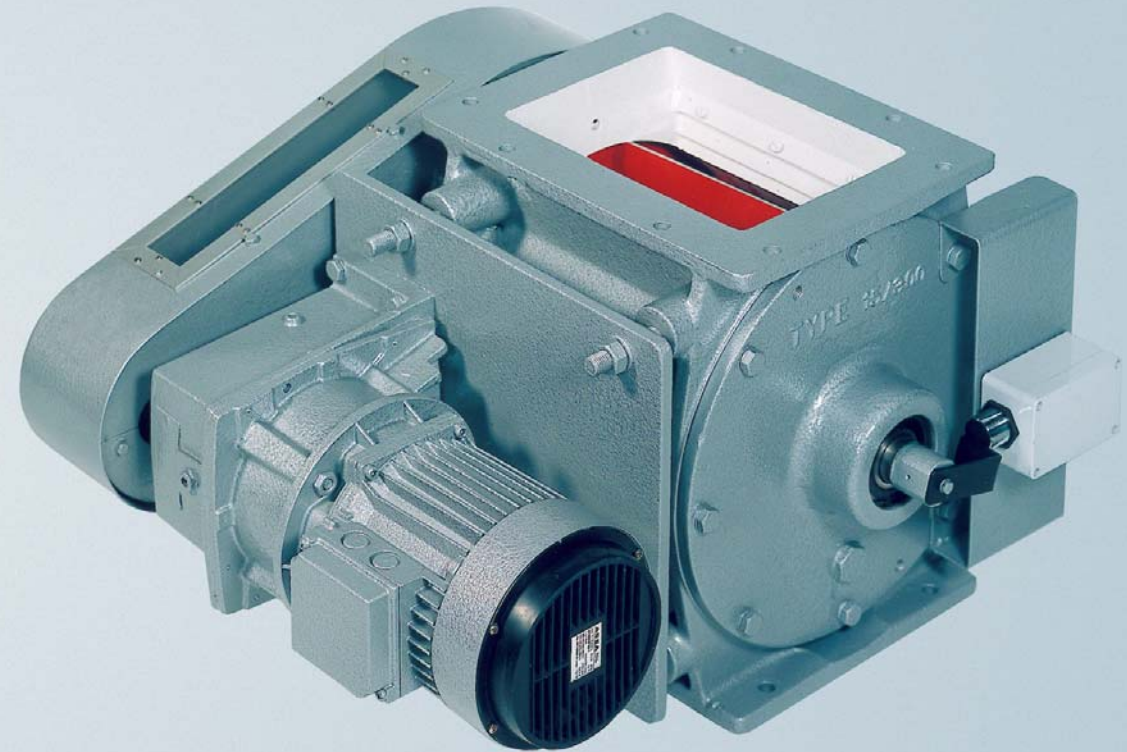

Rotary Valve

For the efficient dosing of bulk goods of all kinds from silos and bunkers.



closing

ANLAGENTECHNIKFÜR SCHÜTTGÜTER



ROTARY VALVE ROTARY VALVE



AREAS OF APPLICATION:

The MAHR rotary valves are designed for the measured discharge of powdered bulk goods from silos or bins. According to application, the cast housings are hard-chrome plated inside or as sturdy welded construction. Steel or stainless steel bucket wheels with 8-10 partially slanted cells guarantee quiet running and high operational safety. For the drive, flanged gear motors connected directly via a coupling or through a chain reduction unit are available.

Varying rotational drive speeds and chain gear ratios, hand adjustable control gears or frequency controlled motors permit a fine gradation of the discharge output.

Rotary valves type SZR are suitable for discharge quantities up to 36 m³/hr. Because of their Vulkano gasket moldings this type is especially suited for the attachment of a blow-out shoe.

Even very small quantities can be dosed via special bucket wheels.

Discharge outputs up to more than 300 m³/hr. are facilitated with the series types N and UL. Large-dimensioned roller bearings with radial seals and slanted rotor blades guarantee quiet running and little blockage of the rotor. The type UL with external bearings is suitable for the dosing of hot and abrasive bulk goods, such as, for example, fly-ash and cement. The external bearings guarantee longer service life.

OPERATION:

Rotors with 8-10 cells dose the bulk goods and the rotational speed of the drive motor determines the dosing quantity. A change in the dosing quantity can be effected via a change of the chain wheel, a hand control unit or with frequency controlled motors. Bulk goods can be blown optimally in a low-pressure environment via blow-out shoe and leaking-air removal.

It is possible that 100% filling of cells is not reached; this depends on the bulk goods and their flow properties.

MATERIAL / DESIGN:

Rotary valves of type SZR with cast housing and rotor blades for small to medium discharge quantities are made of steel or stainless steel. Type N and UL rotary valves are hard chrome-plated inside with ground cast iron housings and rotor blades of steel or stainless steel and with slanted rotor blades. Sizes 200/620 and 300/650 are of heavy, welded construction. Lacquering is hammertone, silver grey; other finishes on request.

TECHNICAL DATA:

Rotary valves with the motor placed above the chain wheels permit a short building style. Rotary speed control and large-sized motors with temperature control via posistors assure operational safety.

ADVANTAGES:

- Permanently lubricated ball bearings
- Quiet running due to slanted cells of the bucket wheel
- Wear protection through hard-chrome plating

DIMENSION TABLE + DIMENSIONED DRAWING ROTARY VALVE TYPE SZR - DN 300

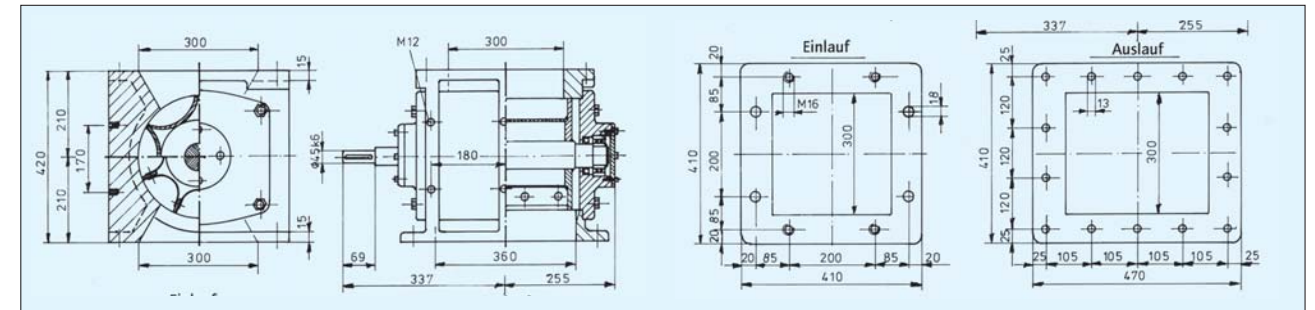

Type	theoret. displaced vol. 25 rpm (m ³ /h)	Displaced volume (l)	Inlet (mm x mm)	Total height (mm)	Total length(mm)	Total width (mm)	weight (kg) 1*	weight (kg) 2*
SZR 300/7,4	12	7,4	300 x 300	420	595	410	200	250
SZR 300/11,4	18	11,4	300 x 300	420	595	410	200	250
SZR 300/13	20	13	300 x 300	420	595	410	200	250

1* = weight without gear • 2* = weight with gear

DIMENSION TABLE + DIMENSIONED DRAWING ROTARY VALVE TYPE SZR - DN 200

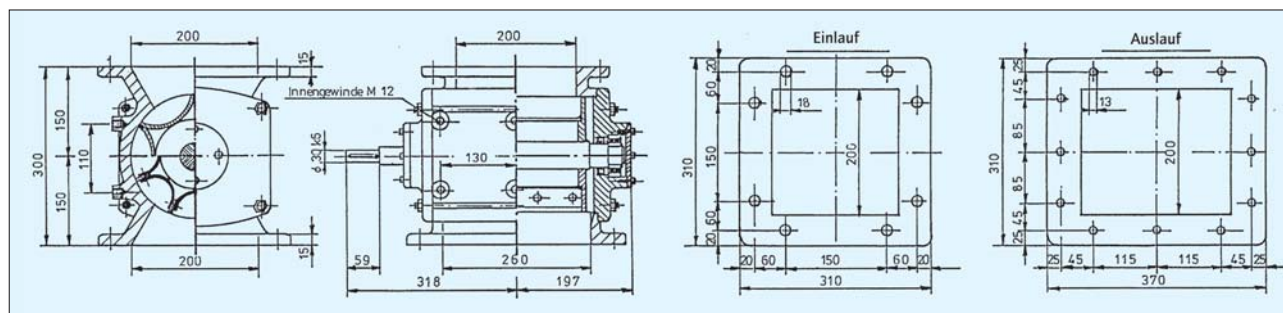

Type	theoret. displaced vol. 25 rpm (m ³ /h)	Displaced volume (l)	Inlet (mm x mm)	Total height (mm)	Total length(mm)	Total width (mm)	weight (kg) 1*	weight (kg) 2*
SZR 200/0,6	1,0	0,6	200 x 200	300	520	310	80	120
SZR 200/1,8	3,5	1,8	200 x 200	300	520	310	80	120
SZR 200/3,2	6,0	3,2	200 x 200	300	520	310	80	120
SZR 200/4,3	7,5	4,3	200 x 200	300	520	310	80	120

1* = weight without gear • 2* = weight with gear

DIMENSION TABLE + DIMENSIONED DRAWING ROTARY VALVE TYPE SZR - DN 350

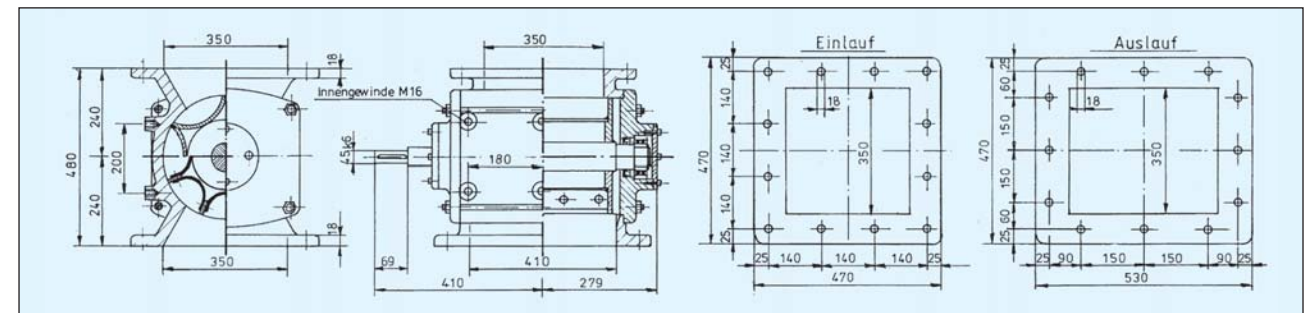

Type	theoret. displaced vol. 25 rpm (m ³ /h)	Displaced volume (l)	Inlet (mm x mm)	Total height (mm)	Total length(mm)	Total width (mm)	weight (kg) 1*	weight (kg) 2*
SZR 350/18	25	18	350 x 350	480	690	410	220	270
SZR 350/24	35	24	350 x 350	480	690	410	220	270

1* = weight without gear • 2* = weight with gear